

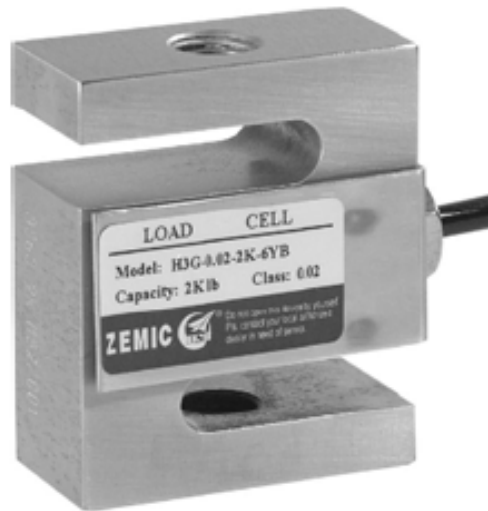

Type H3G Load Cell



Short description



- Nickel plated alloy steel IP67 "S" type load cell
- Tension and compression applications
- Suitable for hanging, hopper and other weighing devices
- Also available in imperial capacities and dimensions

 test certificate no. TC7866 Revision 0
C of C no R60/2000-CNI-00.01

 Certificate no. 06-099A1

Available models

	Accuracy	Full article description
50kg	C3	H3G-C3-50kg-6B
100kg	C3	H3G-C3-100kg-6B
200kg	C3	H3G-C3-200kg-6B
250kg	C3	H3G-C3-250kg-6B
500kg	C3 Excluded from OIML	H3G-C3-500kg-6B
1t	C3 Excluded from OIML	H3G-C3-1t-6B
2.5t	C3 Excluded from OIML	H3G-C3-2.5t-6B
5t	C3 Excluded from OIML	H3G-C3-5t-6B
7.5t	C3 Excluded from OIML	H3G-C3-7.5t-6B

Specifications and dimensions are subject to change without notice and do not constitute any liability whatsoever.

Type H3G Load Cell

Detailed specifications H3G

Accuracy class		OIML R60 C3	C3
Output sensitivity (= FS)	mV/V	3.0 ± 0.008	
Maximum capacity (E _{max})	t	0.05, 0.1, 0.25	0.5, 1, 2.5, 5, 7.5
Max.number of load cell intervals	n _{LC}	3000	
Ratio of min. LC verification interval	$Y = E_{max} / v_{min}$	15000	14000
Combined Error	%FS	≤± 0.020	
Minimum dead load	Of E _{max}	0%	
Safe overload	of E _{max}	150 %	
Ultimate overload	of E _{max}	300 %	
Zero balance	of FS	< ± 1.0 %	
Excitation, recommended voltage	V	5 ~ 12	
Excitation maximum	V	18	
Input resistance	Ω	430 ± 60	
Output resistance	Ω	351 ± 2.0	
Insulation resistance	MΩ	≥5000 (at 50VDC)	
Compensated temperature	°C	-10 ~ +40	
Operating temperature	°C	-35 ~ +65	
Storage temperature	°C	-40 ~ +70	
Element material		Nickel plated alloy steel	
Ingress Protection (acc. to EN 60529)		IP67	
Recommended torque on fixation	Nm	M8:25	M12:75 M20:450 M24:750
ATEX classification (optional)		II1G Ex ia II1C T4	II1D Ex iaD 20 T73°C II3G nL IIC T4

Wiring

Wiring:

Shielded, 4 conductor cable.

Cable diameter: Ø5mm.

Standard cable length: 6m.

Shield not connected to element.

4-wire diagram

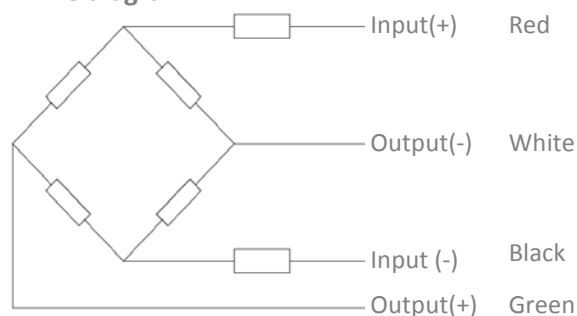

Specifications and dimensions are subject to change without notice and do not constitute any liability whatsoever.

Type H3G Load Cell

Dimensions in mm

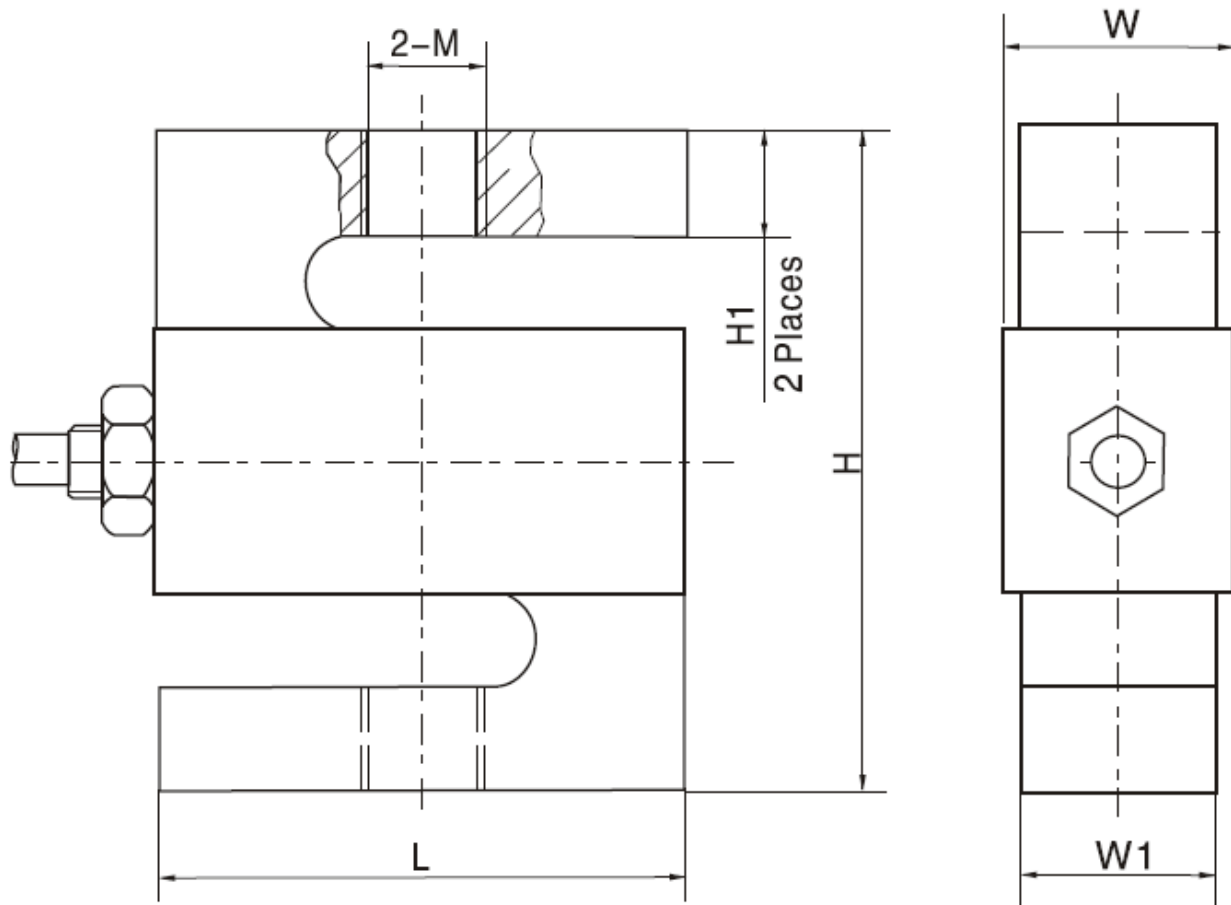

Dimension Capacity	L	H	H1	W1	W	H1	M
50-100kg	50.8	63.5	10.16	12.7	16.5	10.2	M8
250-500kg	50.8	63.5	10.16	19.05	22.8	10.2	M12
1t	50.8	63.5	10.16	25.4	29.2	10.2	M12
2.5t	76.2	101.6	15.2	25.4	29.2	15.2	M20 x 1.5
5t	76.2	101.6	20	25.4	29.2	20	M20 x 1.5
7.5t	101.6	139.7	30	31.75	35.5	31	M24 x 2

Specifications and dimensions are subject to change without notice and do not constitute any liability whatsoever.

Type H3G Load Cell

Available accessories

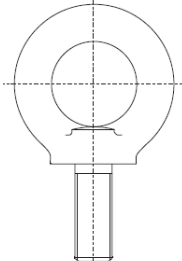
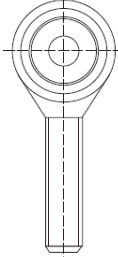
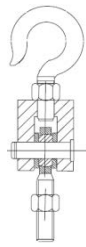
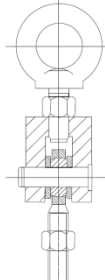
<p>HL-3-001-25kg-5t hook</p> <ul style="list-style-type: none">• Alloy Steel• Suitable for hybrid scales, crane scales, packaging scales and hopper scales	
<p>HL-3-002-25kg-5t eye</p> <ul style="list-style-type: none">• Alloy Steel• Suitable for hybrid scales, crane scales, packaging scales and hopper scales	
<p>HL-3-003-25kg-5t rod end</p> <ul style="list-style-type: none">• Alloy Steel• Suitable for hybrid scales, crane scales, packaging scales, hopper scales and other electronic weighing devices.	
<p>HL-3-004-25kg-5t hook assembly</p> <ul style="list-style-type: none">• Alloy Steel• Suitable for hybrid scales, crane scales, packaging scales, hopper scales and other electronic weighing devices.	
<p>HL-3-005-25kg-5t eye assembly</p> <ul style="list-style-type: none">• Alloy Steel• Suitable for hybrid scales, crane scales, packaging scales, hopper scales and other electronic weighing devices.	

Specifications and dimensions are subject to change without notice and do not constitute any liability whatsoever.